

SIGHT GLASS SO SERIES

Weleding– On Vessel Type
Low Pressure System Used

Technical Data

Size: 1"~10" available
Pressure Limit: Up to 5 bar (kg/cm²); depending on request size
Temperature Limit: Up to 280°C
Material: Wetted part & Body–SS304, SS316 and others on request
 Sight Glass–Transparent tempered glass
 Bolt–SS304 and others on request



Dimensions

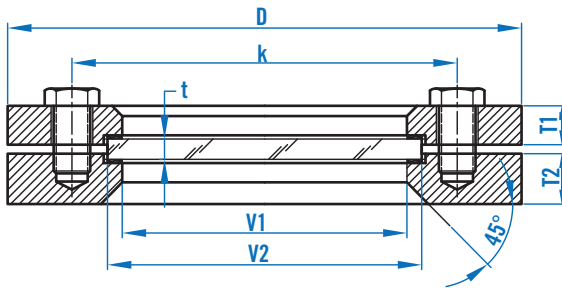

unit=mm

| Size (inch) | 1" | 2" | 3" | 4" | 5" | 6" | 8" | 10" |
|------------------------------|-----|-----|-----|-----|-------|-------|-------|-----|
| Pressure Limit (bar) | 5 | 5 | 5 | 5 | 5 | 5 | 4 | 3 |
| V1 – Visible Diameter | 50 | 80 | 100 | 125 | 150 | 175 | 225 | 300 |
| V2 – Visible Diameter | 60 | 89 | 114 | 150 | 175 | 200 | 250 | 325 |
| t – Tempered Glass Thickness | 10 | 10 | 12 | 15 | 19 | 19 | 25 | 25 |
| D – Flanges O.D | 100 | 150 | 177 | 202 | 228 | 254 | 304 | 405 |
| T1 | 20 | 20 | 20 | 20 | 25 | 25 | 30 | 35 |
| T2 | 25 | 25 | 28 | 35 | 38 | 40 | 45 | 50 |
| Bolts (Pitch) | 78 | 127 | 152 | 178 | 204 | 229 | 280 | 366 |
| Bolt No. | 4 | 4 | 4 | 8 | 8 | 8 | 8 | 8 |
| Bolt Size | M12 | M12 | M12 | M12 | M12 | M12 | M12 | M12 |
| Bolt Length | 30 | 30 | 30 | 35 | 35/45 | 35/45 | 40/45 | 45 |

Parts List

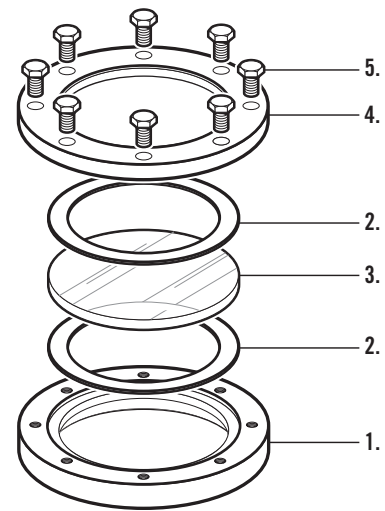

| Item | Part Name |
|------|----------------|
| 1. | Body |
| 2. | Gasket |
| 3. | Tempered Glass |
| 4. | Cover |
| 5. | Bolt |

Ordering Informaion

| SO | Code | Body Material | | | | |
|-----------|------|---------------|-------------------------------|--------|--------|---------|
| | 1 | SS304 | 2 | SS316 | 3 | Option |
| | | Code | Size | | | |
| | | | (1) 1" | (2) 2" | (3) 3" | (4) 4" |
| | | | (5) 5" | (6) 6" | (7) 8" | (8) 10" |
| SO | | | Complete Ordering Code | | | |